

PRO TECH

QUICK GUIDE

BATTERY-POWERED POLE SAW

Assembly

Tools/supplies needed: Pole Saw Tool (included), gloves

1. Align the Locking Spring Pin at the end of the Saw Motor Section and the Pin Locking Hole in the Handle Section (**Figure 1a**).
Note: Also, the opposite side has arrows on a Tab and Slot indicating section alignment (**Figure 1b**).
2. Push the Sections together until the locking Spring Pin clicks into the Locking Hole in the Handle section.
3. Secure the sections together with the Locking Knob and Nut (**Figure 2**).
4. Clip the Strap Hook into the hole in the Strap Buckle (**Figure 3**).
5. Remove the Locknut securing the Sprocket Cover and remove the Sprocket Cover (**Figure 4**). Warning: never handle the chain unless you are wearing gloves.
6. Install the saw chain into the groove of the bar and straighten any kinks (**Figure 5**). The sharp side of the teeth should face in the direction of the chain rotation. If they face backwards, turn the chain around. Form a loop with the chain at the back end of the bar.
7. Hold the chain in position on the bar and place the loop around the Sprocket (**Figure 6**). Position the bar slot over the Stud and pull the bar forward to remove any slack in the chain.
8. If the Tensioner Pin does not align with the hole in the Bar, the Pin must be adjusted as described in the next step.
9. Turn the Chain Tension Screw (**Figure 7**) clockwise to move the Bar away from the Sprocket or counterclockwise to move it towards the Sprocket until the Pin goes into the hole in the Bar.
10. Hold the Bar in position as you position the Sprocket Cover against the Bar (**Figure 4**). Install the Nut until it is almost all the way in but not tight.

BATTERY NOTICE

- Charge battery full before first use
- Try not to charge at below 0°C
- Compatible with +62 volt 5.0AH and 2.5AH Battery

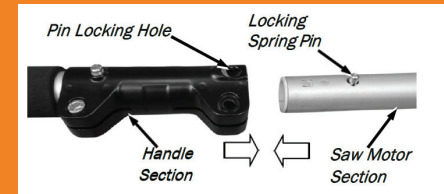

Figure 1a

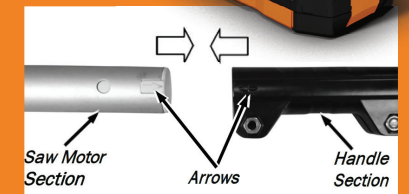

Figure 1b



Figure 2

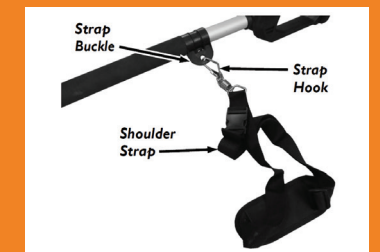

Figure 3

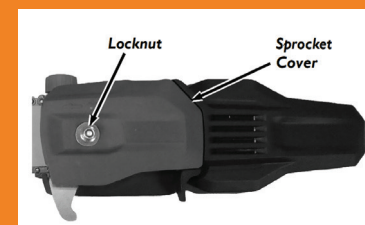

Figure 4

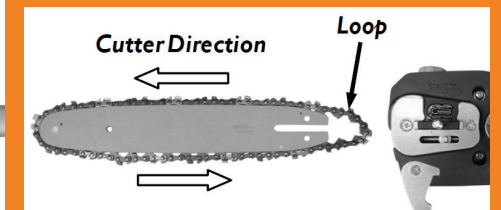

Figure 5

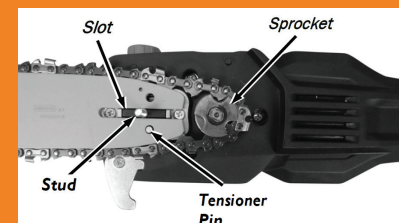

Figure 6



Figure 7

11. Adjust the chain tension by turning the Chain Tension Screw (**Figure 7**) clockwise until there is no sag in the underside of the chain. Finish tightening the Sprocket Cover Nut when the chain is tensioned properly. The chain is correctly tensioned when there is no sag on the underside of the guide bar, the chain is snug, but can still be turned by hand (wear gloves) without binding.
12. The Bar and Chain requires lubrication to reduce friction and wear. Bar and Chain Oil is not supplied with the Pole saw. You can purchase it at your local hardware store. Remove the Oil Tank Cap and add the oil to the “MAX” level on the side of the Tank (**Figure 8**). Install the Cap when finished.
13. Slide the Battery Pack into the Battery cradle on the Pole Saw Handle section, aligning the ribs in the cradle with the slots in the Battery until it is latched into place (**Figure 9**).

How to use

1. Firmly grip the Rear Handle with your right hand and the Pole Handle with your left hand - whether you are right or left handed (**Figure 10**).
2. Push the Lock-Off Button in with your right thumb and squeeze the Trigger ON/OFF Switch with your fingers. Once the Motor starts you can remove your thumb from the Lock-Off Button. If the Saw does not start, make sure the Battery Pack is charged and locked firmly into place in the Saw Housing.
3. To stop the Saw, simply release the Trigger ON/OFF Switch.

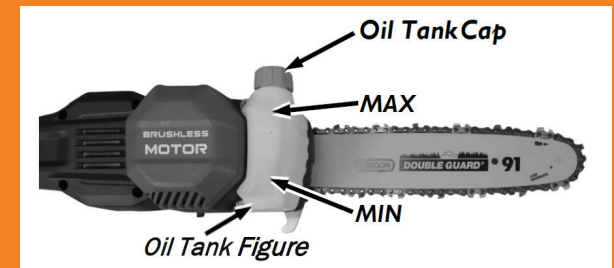

Figure 10

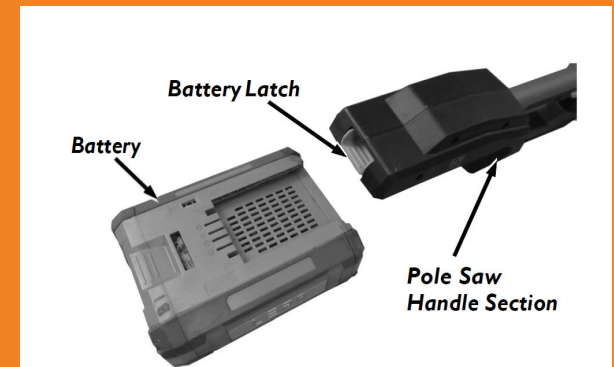

Figure 10

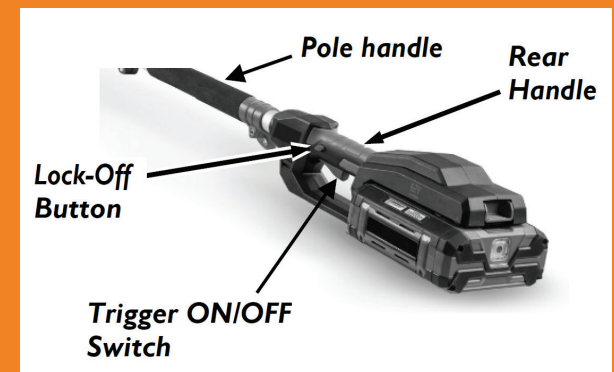

Figure 10